

# Required Parts For All Heat Stress Monitor Calibration

**Sensors must belong  
to Heat Stress Monitor  
being tested**

*(Note: Some Makes and Models  
may have Sensors permanently attached to the unit)*

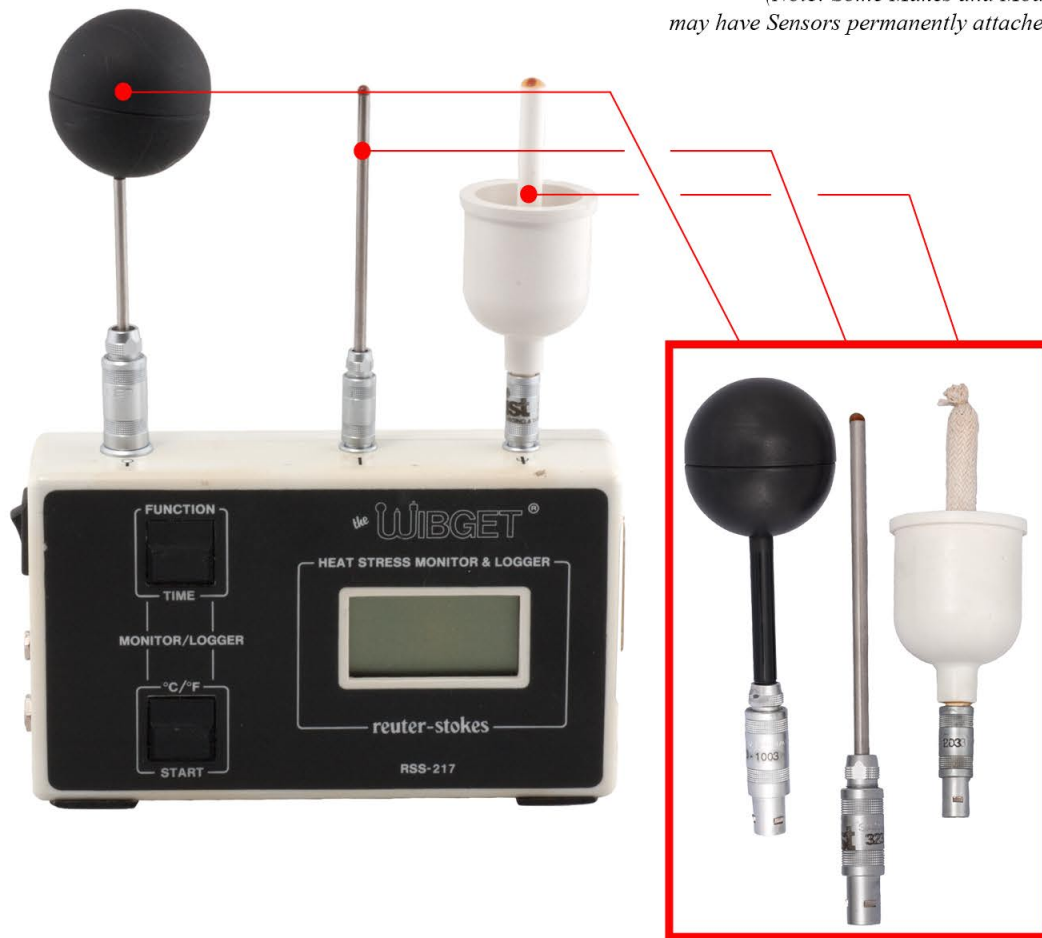

*It is highly recommended to send Heat Stress Monitors  
to CTC in the Manufacturer's case to provide additional  
protection. Equipment should be packaged properly  
according to the :  
Procedure for Packing Equipment to CTC.*

**Sensors**

[http://intranet.osha.gov/dts/LAP/dts/ctc/packing\\_procedure.pdf](http://intranet.osha.gov/dts/LAP/dts/ctc/packing_procedure.pdf)

*(Note for shipping Heat Stress Monitors: Check all compartments to  
ensure probes are present, see pictures below - may vary by Make or Model)*

